

Photo Spots outside the Museum



Foundation of Saga Castle Keep



South-west Turret Foundation and Stone Block with Repair Record Engraved on it

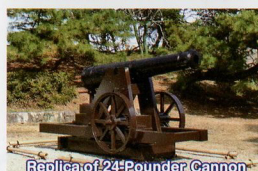

Replica of 24-Pounder Cannon



- Please follow the numbers indicated in the guidebook as you tour around.
- An audio guide is available at the ticket counter.
- Try the “Saga Castle Navigation Let’s” on your smart phone.

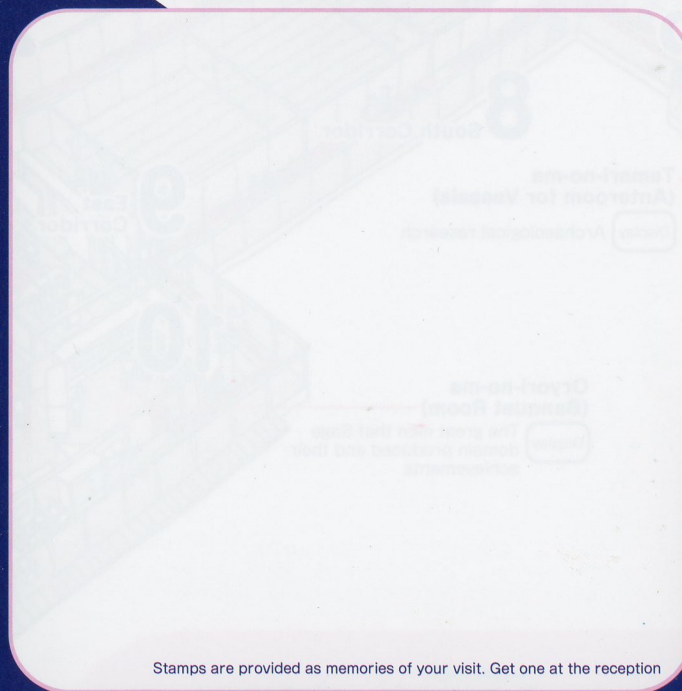

Stamps are provided as memories of your visit. Get one at the reception

Saga Prefectural Saga Castle History Museum

2-18-1 Jonai, Saga City, Saga Prefecture TEL: (+81) 0952-41-7550

Open: 9:30~18:00

Admission free (Donations are greatly appreciated.)

Saga Prefectural Saga Castle History Museum [Search](#)

Saga Prefectural Saga Castle History Museum Illustrated Map of the Museum

Saga Prefectural Saga Castle History Museum

One of the largest wooden structures in Japan

3 Highlights of the Building

Ranked 1st
"Sotogoshoin".

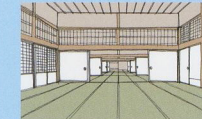

The spacious Hall has 320 tatami mats laid in its flooring

Ranked 2nd
North Corridor.



The corridor is 45 meters long.

Ranked 3rd
Goza-no-ma / Kannindokoro (Private Quarters)

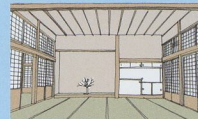

The rooms date all the way back to the Edo Era.

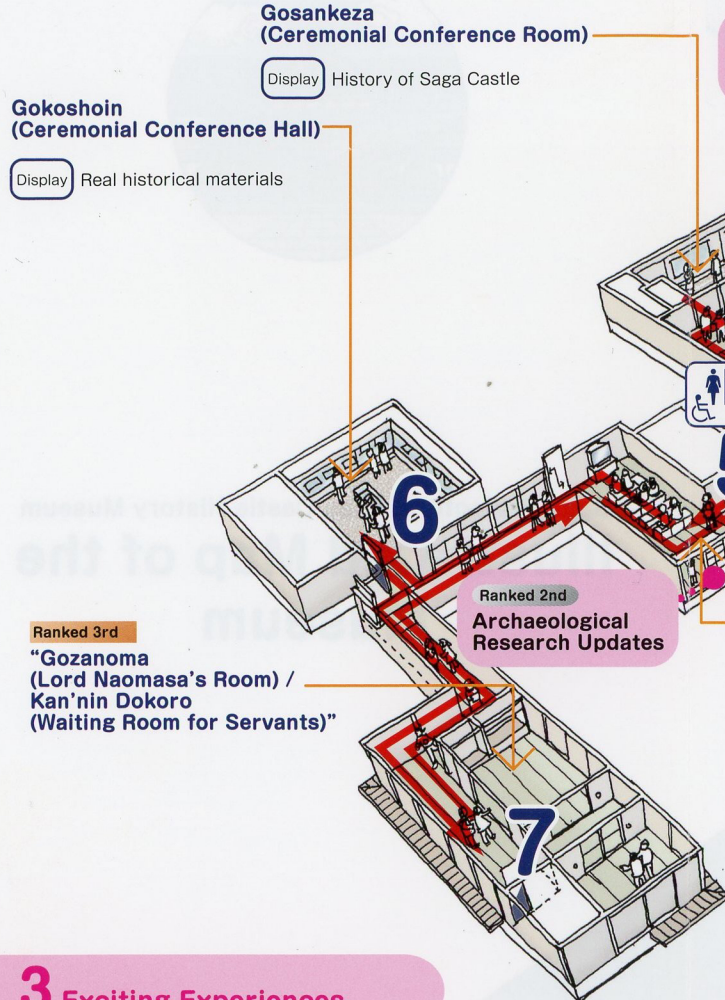

3 Exciting Experiences

Ranked 1st
Hizen Saga Bakumatsu-Meiji Restoration Expo Memorial Exhibition Kodokan



Discovering the Power of Education to Change the World

Ranked 2nd
Archaeological Research Updates



Watch the excavation work from a bird's eye view!

Ranked 3rd
"Karakuri Window" (Computer Photo Editing)



"Narikiri Camera" (Costume Photo Shoot)
Stand side by side with Lord Naomasa!
Dress up as a samurai or a princess and take a photo!

*The display may from time to time be placed at other locations.

Legend

- Toilet
- Nursing Room
- Reception / Museum Shop
- Locker Room
- Information Center
- Lobby
- AED (Automated External Defibrillator)